

ON-PREMISES PRODUCT OVERVIEW

Cabinet hardmount washer-extractors

Softmount washer-extractors

Tumble dryers

Stack tumble dryers

Front load washers

Top load washers

Single dryers

Stack washer/dryers

Commercial flatwork finishers

Fire gear cabinets



BUILT SMART. BUILT FOR SUCCESS.

Maximized throughput, minimized costs. That's the name of the game in on-premises laundry (OPL). At Huebsch, our commercial laundry equipment is durably built to accelerate performance—*while* reducing utilities and overall operating costs—so you can work smarter, not harder.

Built to thrive in demanding environments, Huebsch equipment is constructed using premium metal components and is quality-assured in our state-of-the-art test lab to guarantee uncompromising performance. And with the most comprehensive support network in the industry, Huebsch makes reaching your laundry goals easier than ever.

OPL solutions for...

- Hospitality
- Healthcare
- Correctional facilities
- Athletic facilities
- Veterinary clinics
- Salons and spas
- Fire departments
- Other OPL facilities



LAUNDRY. IT'S ALL WE DO.

As part of the world's largest commercial laundry company, we help you achieve success through more specialized expertise than anyone else in the industry.

Intelligent laundry design

From preliminary drawings to completed layouts, you can rely on our dedicated team of laundry experts to assist you with your on-premises laundry design.

Distributors

True laundry experts, our knowledgeable distributors offer guidance, service and support.

We work for you

We're committed to world-class customer service at every interaction.

Genuine parts

Same design. Same reliability.

The perfect maintenance solution.



DEDICATED TO YOUR INDUSTRY.

Hospitality

Huebsch high-efficiency laundry systems are designed to meet the challenges posed by treating larger terry items and high-quality bedding, and by providing the highest productivity, lowest operating costs, and results that keep guests checking in.

Healthcare

Healthcare facilities demand the highest levels of infection control. High-quality equipment is simply nonnegotiable—and neither is the utmost consistency in cycles, including water temperatures optimal for the laundry chemicals being used.

Correctional facilities

Correctional facilities demand large-capacity machines to process high laundry quantities in short amounts of time. Simple, user-friendly controls keep loads moving. Durability is a must—as is water and energy efficiency—to keep operating costs low.

Athletic facilities

Towels make up the majority of laundry loads at gyms and fitness centers, so higher spin speeds to remove more water and shorten drying times are crucial to cutting down on utility consumption.



Veterinary clinics

Whether it's a small space that can get by with one commercial washer/dryer combination or a large operation that requires cabinet-style washer extractors, consistency and reliability in veterinary clinics is vital.

Salons and spas

Salons often benefit from washing towels with commercial, manual-control washers and dryers, while spas are best served by washer-extractors to attain high extract speeds, removing more water from larger loads and cutting down drying times.

Fire departments

Programmable controls enable operators to utilize lower-speed wash and extract cycles to maintain gear integrity while thoroughly removing carcinogens in accordance with NFPA 1851 recommendations. Highly efficient dryers cut down dry times, ensuring gear is clean and ready when the alarm sounds.

Other businesses and industries

For other on-premises laundry applications, managers must evaluate the volume and type of linens, as well as the space available. Smaller operations may need small, commercial, manual-control units versus larger businesses that may be laundering larger, thicker linens and demand washer-extractors and drying tumblers.

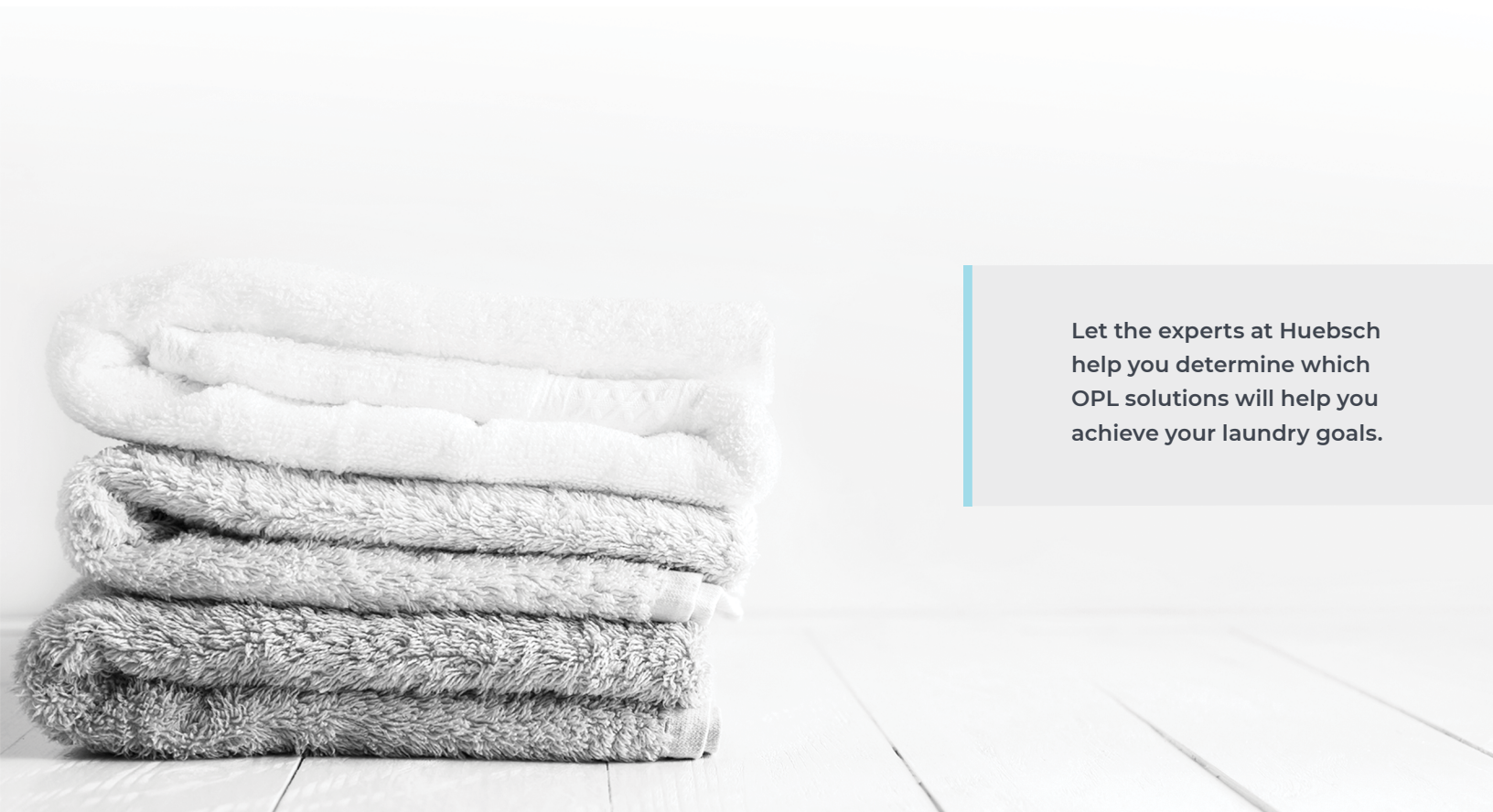

Let the experts at Huebsch help you determine which OPL solutions will help you achieve your laundry goals.

CABINET HARDMOUNT WASHER-EXTRACTORS

Hardmount washer-extractors* are the industry standard for hotels, healthcare facilities and other ground-floor laundries. These heavy-duty units are secured to the concrete floor and have a proven record of reliability, longevity and superior wash results.

Huebsch machines are also designed to extend linen life, reduce utility usage and maximize productivity. Our durable construction guarantees your washer-extractor will be in service for years to come, while our high G-Force extraction removes more water from each load, reducing energy costs and shortening drying times.

CABINET HARDMOUNT WASHER-EXTRACTOR CONTROLS



Galaxy™ 400 with eBoost™

Customize your washing power with the ability to choose between three water levels while eliminating wasted water with advanced leak detection. PC programming, audit data retrieval and advanced diagnostics save time, while 200 G-Force extraction speeds reduce drying time and utility consumption.



Galaxy 200

For laundry managers requiring basic management options, Galaxy 200 offers a vigorous 100 G-Force extraction speed, four cycle selections, two water levels and manual programming.

FEATURES

- Proprietary inverter-drive technology provides smooth, reliable power, saving you 33% on electricity and 11% on water while maximizing cleaning power.
- Computer-optimized, heavy-duty frame is lighter, lasts longer, balances loads more efficiently, and reduces sound and vibration levels.
- Seals and bearings assembly: Two triple-lip seals and an excluder-face seal for seven layers of water protection.
- Large door design makes loading and unloading fast and easy.
- Available in 20 lb (9.1 kg), 30 lb (13.6 kg), 40 lb (18.2 kg), 60 lb (27.2 kg), 80 lb (36.3 kg) and 100 lb (45.4 kg) capacities.



* Not all models are available in all markets. In order to highlight key details, machine images do not adhere to a standard scale.

SOFTMOUNT WASHER-EXTRACTORS

While the powerful operation of a washer-extractor often requires that the machine be bolted to the floor, softmount washer-extractors* offer an alternative for specialized applications, such as second floors and raised foundations where hardmounting isn't an option.

Heavy-duty suspension absorbs vibrations without the need for special foundations, and stainless-steel construction protects the finish from corrosion. High G-Force extraction significantly reduces drying times and utility costs, removing enough moisture that items can often bypass the dryer and go directly to your flatwork finisher.

SOFTMOUNT WASHER-EXTRACTOR CONTROLS

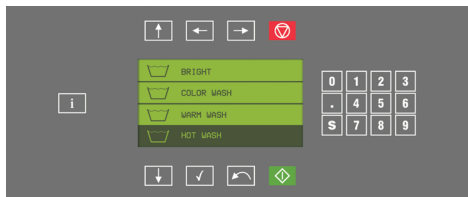

HC200

HC200 provides up to 99 cycle programs. Extremely versatile and easy to use, the advanced computer control meets a variety of specialized needs. With more than 20 languages available, our HC200 is flexible and intuitive for bilingual operators. Users can easily follow the status of every phase of the wash cycle and modify data and parameters at any time to monitor for maximum efficiency.

FEATURES

- High-speed extraction of 350-400 G-Force results in increased throughput.
- Modular bearing-housing design for long life and easy service.
- Strong, oversized door lock and wide-set door hinges provide stability.
- Reinforced side panels for increased strength and durability.
- Large drain valves for increased throughput.
- Stainless-steel front, top and side panels, inner drum and tub.
- Large door openings for easy loading and unloading.
- Easy to install with heavy-duty suspension systems that don't require special foundations.
- Available in 14 lb (6.5 kg), 20 lb (9.1 kg), 25 lb (11.3 kg), 30 lb (13.6 kg), 40 lb (18.2 kg), 55 lb (25 kg), 65 lb (29.5 kg), 75 lb (34.1 kg), 90 lb (40.9 kg), and 125 lb (51.8 kg) capacities.



* Not all models are available in all markets. In order to highlight key details, machine images do not adhere to a standard scale.

TUMBLE DRYERS

Uncomplicated. Uncompromising. Unmatched. Enjoy heavy-duty construction that will provide reliable operation for years to come.

Our single-pocket tumble dryers* feature concentrated airflow and sealed cylinder rims to ensure energy savings. This superior drying performance helps laundries maximize throughput to meet the daily workload every time. Our tumble dryers are designed with fewer moving parts, so you'll face less maintenance or wear and tear.

Huebsch now offers you the choice of two tumbler ranges to best satisfy your needs. The Huebsch ECO-Line of tumblers features lower energy usage compared to our Classic line of tumblers, creating an option with the lowest energy-consumption rates in the industry.

TUMBLE DRYER CONTROLS



Galaxy™

Galaxy offers the flexibility of 30 programmable cycles combined with the accuracy of our moisture-sensing technology saving time and energy increasing the life of your linens, saving time and energy.

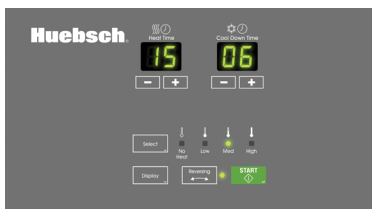

DUAL DIGITAL

With features including one-touch cycle repeat, automatic extended tumble and a large digital countdown display, it's simple to set your drying time, temperature and cool down.

FEATURES

- High-performance heater box increases energy efficiency, reduces drying times and provides low-cost/high-productivity laundry operations.
- Reversing cylinder helps eliminate tangles of large items, ensuring even drying and easy removal of loads at cycle completion.
- The 55 lb (24.9 kg) capacity model also fits through a 36 in (914 mm) door opening and is 10 in (251 mm) shorter than our 50 lb (22.7 kg) unit, making it an option for laundries short on space.
- Available in 25 lb (11.3 kg), 30 lb (13.6 kg), 35 lb (15.9 kg), 50 lb (22.7 kg), 55 lb (24.9 kg), 75 lb (34 kg), 120 lb (54.4 kg), 170 lb (77.1 kg) and 200 lb (90.7 kg) capacities.

OPTIONAL UPGRADE

- The Combustion Automated Response Equipped (C.A.R.E.™) system alerts you to abnormally high temperatures in the cylinder and automatically sprays water to cool it down if necessary.
- Available Over-Dry Prevention Technology eliminates the costs associated with overdrying.



* Not all models are available in all markets. In order to highlight key details, machine images do not adhere to a standard scale.

STACK TUMBLE DRYERS

Our line of stack tumble dryers* provides double the capacity of Huebsch single-pocket tumble dryers while using only half the floor space. Plus, you'll still only need one set of gas, electric and exhaust hookups, simplifying installation.

The T45 boasts 90 lb (40.8 kg) of rated capacity between its two sizable—yet efficient—cylinders, making it an excellent alternative to single 75 lb (34 kg) units.

Huebsch also offers the ECO-Line of stack tumblers, featuring lower energy input and usage compared to our Classic line of tumblers. This range offers a solution for users aiming for the lowest energy-consumption rates in their industry.

STACK TUMBLE DRYER CONTROLS



Galaxy™

Galaxy offers the flexibility of 30 programmable cycles combined with the accuracy of our moisture-sensing technology that prevents overdrying, saving time and energy.



DUAL DIGITAL

With features including one-touch cycle repeat, automatic extended tumble and a large digital countdown display, it's simple to set your drying time, temperature and cool down.

FEATURES

- Large, easy-to-clean lint compartment.
- Fewer moving parts mean fewer maintenance problems and less wear.
- High-performance heater box increases energy efficiency, reduces drying times and provides low-cost/high-productivity laundry operations.
- Axial airflow pattern with sealed cylinder rims delivers the fastest, most efficient drying results in the industry.
- Available Over-Dry Prevention Technology eliminates overdrying costs.
- Available in 30 lb (13.6 kg) per pocket and 45 lb (20.4 kg) per pocket capacities.



* Not all models are available in all markets. In order to highlight key details, machine images do not adhere to a standard scale.

FRONT LOAD WASHERS

The efficiency you need to reduce operating costs, from low water usage to high-speed extraction. Our front load washers* use as little as 11.7 gallons (44.3 liters) per cycle, saving 40 percent more than many commercial top load washers. Fast cycle times get the job done quickly, while a larger-capacity cylinder provides room for larger loads.

FRONT LOAD WASHER CONTROLS

ELECTRONIC CONTROL

The electronic control keeps users informed throughout the wash process with cycle-status lights and a digital cycle countdown. Users also have the flexibility to control temperature, load type and soil levels, as well as options for prewash and/or additional rinse to achieve high levels of efficiency.



FEATURES

- Improved suspension with new out-of-balance logic manages and redistributes unbalanced loads for uninterrupted wash cycles.
- High spin speed up to 440 G-Force removes more water from clothes, speeding up drying cycles and lowering dryer energy usage.
- A pump drain allows our front load washers to be installed adjacent to or replace top load washers with no special plumbing. (A gravity drain option is also available.)
- Available in 21.5 lb (9.5 kg) capacity.



* Not all models are available in all markets. In order to highlight key details, machine images do not adhere to a standard scale.

TOP LOAD WASHERS

As timeless as they are reliable, Huebsch top load washers* are built from the ground up from heavy-duty components guaranteed to stand up to rigorous use. Compliant with U.S. and many international water and energy standards for commercial washers, your laundry will realize significant savings in water and energy costs.

TOP LOAD WASHER CONTROLS

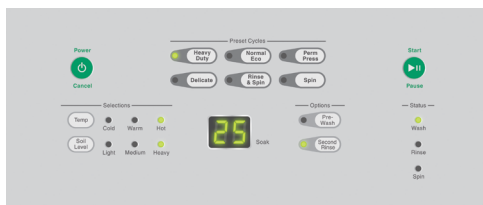

ELECTRONIC CONTROL

The electronic control keeps users informed throughout the wash process with cycle-status lights and a digital cycle countdown. Users also have the flexibility to control temperature, load type and soil levels, as well as options for prewash and/or additional rinse to achieve high levels of efficiency.

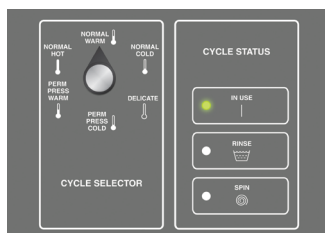

E-MECH

The E-Mech control features an intuitive design offering users simple water-temperature and fabric selections while using cue lights to monitor progress through the wash cycle (available on rear-control models only).

FEATURES

- Designed for durability and ease of use with push-to-start switch and reinforced control knobs.
- Extra-large capacity, stainless-steel tub keeps clothes looking their best.
- Advanced suspension system helps manage unbalanced loads.
- Commercial-quality, all-metal transmission offers highest quality and durability.
- Multi-cycle controls provide flexible washing options to fit your laundry needs.

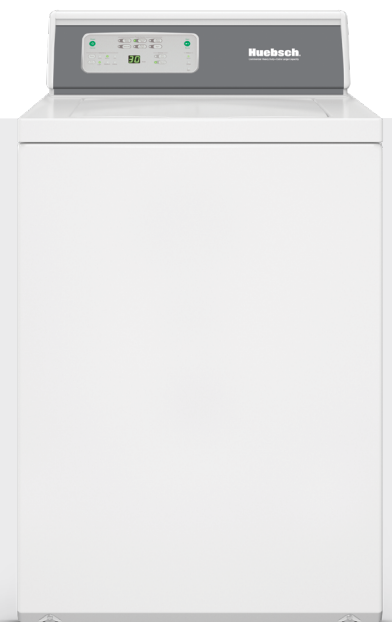

* Not all models are available in all markets. In order to highlight key details, machine images do not adhere to a standard scale.

SINGLE DRYERS

With a large load capacity in a compact frame, each one of our single dryers* is all business, all the time. With an easy-to-clean lint compartment and the industry's largest 2.06 sq ft (1,913.8 sq cm) reversible door for faster loading and unloading, Huebsch single dryers are designed to suit your needs.

SINGLE DRYER CONTROLS

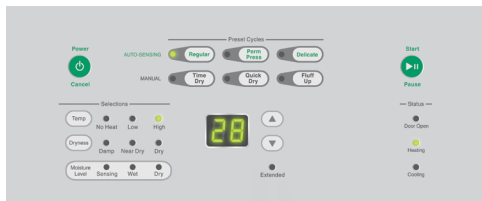

ELECTRONIC CONTROL

The electronic control keeps users informed throughout the drying process with cycle-status lights and a digital cycle countdown. Users also have the flexibility to control temperature and dryness levels to achieve high levels of efficiency. Automatic (moisture-sensing) cycles come standard to prevent overdrying of your linens.

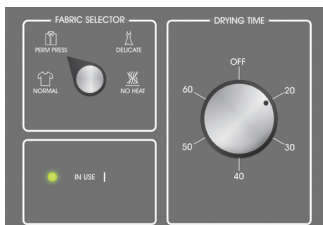

E-MECH

The E-Mech control features an intuitive design offering users simple fabric selections and drying time while using cue lights to monitor progress through the drying cycle (available on rear-control models only).

FEATURES

- Durable, galvanized-steel cylinder with an extra-large 7 cu ft (198L) of volume.
- Efficient dryer heating with 20,000 Btu (5,043 kCal) (gas models) and up to 5,200 W (electric models).



* Not all models are available in all markets. In order to highlight key details, machine images do not adhere to a standard scale.

STACK WASHER/DRYER

Get the complete package in a single unit, combining our efficient dryers with the powerful performance of our industry-leading front load washers. Our line of stack washer/dryers* are designed as vertical combinations that provide all of the power of Huebsch washers and dryers while occupying only half of the floor space of a conventional washer and dryer setup. Plus, these stacked units allow you to use the same connections and hookups required as a standard washer and dryer, so you won't have to make changes to your installation.

STACK WASHER/DRYER CONTROLS

ELECTRONIC CONTROL

The electronic control keeps users informed throughout the wash process with cycle-status lights and a digital cycle countdown. Users also have the flexibility to control temperature, spin speeds and soil levels, as well as the option of a prewash and/or additional rinse to achieve high levels of efficiency. Automatic (moisture-sensing) cycles come standard to prevent overdrying of your linens.



FEATURES

- Improved suspension with new out-of-balance logic manages and redistributes unbalanced loads for uninterrupted wash cycles.
- Water use is trimmed to 11.7 gal (44.3L) per cycle to reduce operating costs.
- Available in 21.5 lb (9.5 kg) washer capacity and 18 lb (8.1 kg) dryer capacity.



* Not all models are available in all markets. In order to highlight key details, machine images do not adhere to a standard scale.

COMMERCIAL FLATWORK FINISHERS

QUALITY BY DESIGN

Our heated-cylinder finishers are equipped with a frequency-controlled motor, suspended roll and Nomex® ironing belts to deliver top-of-the-industry results.

THE RIGHT SIZES

Huebsch Flatwork Finishers are offered in finished widths of 55, 66, 79, 82, 102 and 126 inches meaning there's a size to fit the needs of any size laundry.

EXCELLENT EFFICIENCY

Thick, polished-steel cylinders maintain even heat and help make the finishers highly efficient. A totally enclosed cabinet also contributes to its energy efficiency.

MICROPROCESSOR CONTROL

Huebsch's versatile microprocessor control enables you to store temperature and speed settings to ensure consistent, top-quality results. Temperatures can be set up to 355°F and there are multiple speed settings.

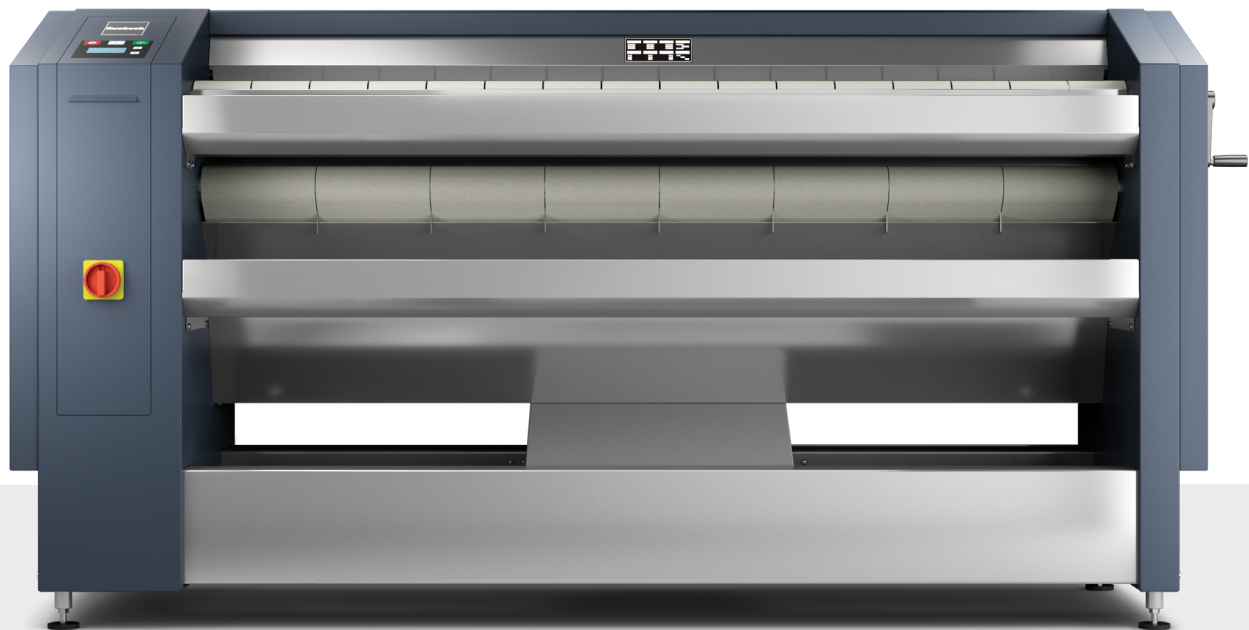

FIRE GEAR CABINETS

Huebsch Fire Gear Cabinets are engineered to comply with all NFPA 1851 regulations. Efficient drying processes help minimize utility and operating costs and cut drying times down to one-and-a-half to three hours—meaning gear will be ready for action whenever the alarm sounds.

FEATURES

- Keeps firehouses compliant with updated NFPA 1851 regulations.
- A safe alternative to commercial dryers that maintains the protective integrity of your gear.
- Advanced airflow process sends heated air around and inside turnout gear for thorough, efficient drying.
- Fast drying returns gear to service in just 1.5 to 3 hours.
- Easy-to-operate microprocessor control offers 5 preset cycles.
- Presets can be easily programmed to match your department's specific needs.
- Large capacity allows drying of 6 full sets of PPE gear (fire jacket, pants, and liners) and up to 15 boots or gloves at once. Optional racks available for drying additional items such as hoses.
- Durable construction delivers long-lasting, premium drying performance that stands up to the rough demands of your profession.



Vended **Galaxy™ 600 Washer-Extractors** specifications

Models		HCT020	HCT030	HCT040	HCT060	HCT080	HCT100
Control Options		Galaxy™ 600	Galaxy™ 600	Galaxy™ 600	Galaxy™ 600	Galaxy™ 600	Galaxy™ 600
Capacity – lb (kg)		20 (9)	30 (13.6)	40 (18)	60 (27)	80 (36)	100 (45)
Overall Width – in (mm)		26 (660)	29 (737)	30.6 (777)	34.1 (866)	41.5 (1054)	41.5 (1054)
*Overall Depth – in (mm)		30.9 (785)	35.3 (897)	42.3 (1074)	44.7 (1135)	47.1 (1196)	51.1 (1298)
Overall Height – in (mm)		43 (1092)	45 (1143)	47.2 (1199)	49.9 (1267)	57.2 (1453)	57.2 (1453)
Cylinder Diameter – in (mm)		21 (533)	24 (610)	26.3 (668)	30 (762)	36 (914)	36 (914)
Cylinder Depth – in (mm)		13.8 (351)	16 (406)	20.3 (516)	22 (559)	21.9 (556)	25.9 (658)
Cylinder Volume – cu ft (liters)		2.8 (79)	4.2 (119)	6.3 (178)	9 (225)	12.9 (365)	15.2 (430)
Door Opening Size – in (mm)		11.6 (295)	14.3 (363)	16.3 (414)	16.3 (414)	18.5 (470)	18.5 (470)
Door Bottom to Floor – in (mm)		14.4 (366)	14 (356)	14.6 (371)	14.9 (378)	17.9 (455)	17.9 (455)
Water Inlet Connection – in (mm)		2 x 0.75 (19)	2 x 0.75 (19)	2 x 0.75 (19)	2 x 0.75 (19)	2 x 0.75 (19)	2 x 0.75 (19)
Drain Diameter – in (mm)		1 x 3 (76)	1 x 3 (76)	1 x 3 (76)	1 x 3 (76)	1 x 3 (76)	1 x 3 (76)
Drain Height to Floor – in (mm)		3.9 (99)	4.3 (109)	4.5 (114)	4.9 (124)	5.1 (130)	5.1 (130)
Motor Power Consumption – HP(kW)		1 (0.75)	1 (0.75)	2 (1.5)	3 (2.2)	5 (3.7)	5 (3.7)
Total # of Speeds		6, 9	6, 9	6, 9	6, 9	6, 9	6, 9
Cylinder Speeds – RPM (G-Force)	Gentle	37 (0.4)	34 (0.4)	33 (0.4)	31 (0.4)	28 (0.4)	28 (0.4)
	Wash	51 (0.8)	48 (0.8)	46 (0.8)	43 (0.8)	39 (0.8)	39 (0.8)
	Distribution	92 (2.5)	86 (2.5)	82 (2.5)	77 (2.5)	70 (2.5)	70 (2.5)
	Very Low	301 (27)	282 (27)	269 (27)	252 (27)	230 (27)	230 (27)
	Low	518 (80)	485 (80)	464 (80)	434 (80)	396 (80)	396 (80)
	Medium	579 (100)	542 (100)	518 (100)	485 (100)	443 (100)	443 (100)
	High	648 (125)	606 (125)	579 (125)	542 (125)	495 (125)	495 (125)
	Very High	710 (150)	664 (150)	635 (150)	594 (150)	542 (150)	542 (150)
	Ultra High	819 (200)	766 (200)	733 (200)	686 (200)	626 (200)	568 (165)
** Voltage/ Circuit Breaker - FLA	B	120/60/1	15-9	15-12	20-15	N/A	N/A
	X	200-240/50-60/1/3	15-4 (1 Ph) 15-3 (3 Ph)	15-7 (1 Ph) 15-4 (3 Ph)	15-7 (1 Ph) 15-4 (3 Ph)	15-11 (1 Ph) 15-7 (3 Ph)	20-16 (1 Ph) 15-10 (3 Ph)
	Y	200-240/60/1/3 (Pump Drain Only)	15-4 (1 Ph)	15-7 (1 Ph) 15-4 (3 Ph)	15-7 (1 Ph) 15-4 (3 Ph)	N/A	N/A
	N	440-480/50-60/3	15-2	15-3	15-3	15-4	15-6
Shipping Dimensions Approx. – in (mm)	Width	28 (711)	31.5 (800)	32.5 (826)	37.5 (953)	44 (1118)	44 (1118)
	Depth	33.8 (859)	38.3 (973)	43.5 (1105)	46.9 (1191)	54.5 (1384)	58.5 (1486)
	Height	49.4 (1255)	51.3 (1303)	53.6 (1361)	56.3 (1430)	59.6 (1514)	59.6 (1514)
Net Weight – lb (kg)		340 (154)	440 (200)	540 (245)	680 (308)	1250 (567)	1280 (581)
Shipping Weight – lb (kg)		380 (172)	480 (218)	580 (263)	720 (327)	1300 (590)	1330 (603)
Slat Crate Shipping Weight – lb (kg)		460 (209)	580 (263)	680 (308)	840 (381)	1430 (649)	1460 (662)
***Agency Approvals		cULus	cULus	cULus	cULus	cULus	cULus

*Overall depth includes vacuum breaker to door handle.

** Circuit breaker and amp draw data shown are for models without electric heat. Consult factory for other configurations. Manufacturer strongly recommends using a circuit breaker instead of fuses. Use 3-pole circuit breakers for 3-phase machines.

***Agency approvals may vary depending on configuration. Steam connection requires ½" N.P.T. For the most accurate information, the installation guide should be used for all design and construction purposes. Due to continuous product improvements, design and specifications subject to change without notice. The quality management system of Alliance Laundry Systems' Ripon facility has been registered to ISO 9001:2000.

Authorized Distributor:
**ACE Commercial Laundry
Equipment Inc**

1-877-630-7278
14404 Hoover St Westminster, CA 92683
www.ancelaundry.com



Vended **Stack & Single Tumble Dryer** Specifications

Models	HTT30	HTT45	HT050	HT075
Control Options	Galaxy™ 600/500	Galaxy™ 600/500	Galaxy™ 600/500	Galaxy™ 600/500
Capacity – lb (kg)	30 (13) x 2	45 (20) x 2	50 (25)	75 (34)
Width – in (mm)	31.5 (800)	34.5 (875)	38.5 (980)	38.5 (980)
Depth – in (mm)	42.8 (1090)	48.6 (1235)	46.8 (1190)	53.0 (1350)
Height – in (mm)	76.3 (1940)	81.3 (2065)	77.3 (1960)	77.3 (1960)
Cylinder Depth – in (mm)	26.0 (660)	30.0 (762)	30.0 (762)	36.0 (914)
Cylinder Diameter – in (mm)	30.0 (762)	33.0 (838)	37.0 (940)	37.0 (940)
Cylinder Volume – cu ft (liters)	10.6 (300)	14.8 (420)	18.7 (530)	22.4 (634)
Reversing Cylinder	Standard	Standard	Standard	Standard
Door Opening Size – in (mm)	22.6 (574)	26.9 (683)	26.9 (683)	26.9 (683)
Air Outlet – in (mm)	1 x 8 (200) Oval	1 x 10 (250) Oval	8 (200)	8 (200)
Motor - HP	Fan 0.5	0.5	0.5	0.5
	Cylinder 0.3	0.5	0.5	0.5
Airflow – cfm (liters/sec)	2 x 400	2 x 600	700	800
Heat Input Power - Per Pocket – Btu/hr	73,000 x 2	95,000 x 2	122,000	165,000
Gas Connections* – in (mm)	0.5	0.5	0.5	0.5
Electrical Specs - amps	(B) 100-120V/50/60/1 16	20	9	12
	(X) 200-240V/50/60/1/3 9	12	6	7
Shipping Dimensions Approx. – in (mm)	Width 32.5 (826)	35.5 (902)	41.5 (1054)	41.5 (1054)
	Depth 47.0 (1194)	54.0 (1372)	50.0 (1270)	56.0 (1422)
	Height 79.9 (2029)	84.9 (2156)	81.0 (2057)	81.0 (2057)
Net Weight – lb (kg)	570 (260)	710 (320)	660 (299)	690 (313)
Shipping Weight – lb (kg)	600 (270)	750 (340)	710 (322)	740 (336)
Agency Approvals	CSA	CSA	CSA	CSA



Authorized Distributor:
ACE Commercial Laundry Equipment Inc
 1-877-630-7278
 14404 Hoover St Westminister, CA 92683
www.ace laundry.com



Vended **Stack & Single Tumble Dryer** Specifications

Models	HT030	HT035	HT055
Control Options	Galaxy™ 600/500	Galaxy™ 600/500	Galaxy™ 600/500
Capacity – lb (kg)	30 (13)	35 (16)	55 (24)
Width – in (mm)	27.9 (710)	31.5 (800)	34.5 (876)
Depth – in (mm)	45.5 (1155)	45.5 (1155)	53.1 (1350)
Height – in (mm)	63.9 (1625)	63.9 (1625)	66.7 (1700)
Cylinder Depth – in (mm)	30.0 (762)	30.0 (762)	35.0 (889)
Cylinder Diameter – in (mm)	26.5 (673)	30 (762)	33 (838)
Cylinder Volume – cu ft (liters)	9.6 (270)	12.3 (350)	17.3 (490)
Reversing Cylinder	Standard	Standard	Standard
Door Opening Size – in (mm)	22.7 (577)	22.7 (577)	26.9 (683)
Air Outlet – in (mm)	6 (152)	8 (200)	8 (200)
Motor - HP	Fan 0.5	0.5	0.5
	Cylinder 0.3	0.3	0.5
Airflow – cfm (liters/sec)	500	600	700
Heat Input Power - Per Pocket – Btu/hr	73,000	90,000	112,000
Gas Connections* – in (mm)	0.5	0.5	0.5
Electrical Specs - amps	(B) 100-120V/50/60/1 10	10	12
	(X) 200-240V/50/60/1/3 6	6	7
Shipping Dimensions Approx. – in (mm)	Width 30.0 (762)	33.0 (838)	35.5 (902)
	Depth 49.0 (1245)	49.0 (1245)	57 (1448)
	Height 67.6 (1717)	67.6 (1717)	70.5 (1791)
Net Weight – lb (kg)	320 (145)	340 (155)	430 (195)
Shipping Weight – lb (kg)	340 (155)	360 (165)	470 (215)
Agency Approvals	CSA	CSA	CSA

* LP gas available for 50, 75 lb capacities only. Field conversion kits available for other capacities.

Tumble dryer models are made to suit a variety of electrical service characteristics. See your Huebsch distributor for specifications. For further details on installation, refer to Installation, Operation and Maintenance instructions supplied with the tumble dryer. USA and Canada models are certified by CSA International.

For the most accurate information, the installation guide should be used for all design and construction purposes. Due to continuous product improvements, design and specifications subject to change without notice. The quality management systems of Alliance Laundry Systems are registered to ISO 9001.



Authorized Distributor:
ACE Commercial Laundry Equipment Inc

1-877-630-7278
 14404 Hoover St Westminster, CA 92683
www.acelaundry.com

On-Premises **120-lb** Tumble Dryer

Our single-pocket tumble dryers* feature concentrated airflow and sealed cylinder rims to ensure energy savings. This superior drying performance helps laundries maximize throughput to meet the daily workload every time. Our tumble dryers are designed with fewer moving parts, so you'll face less maintenance and wear and tear.



Efficient

High-performance heater box increases energy efficiency and reduces drying times to help on-premises laundries increase throughput, while decreasing operating costs.

Spacesaver

The 55 lb (24.9 kg) capacity model fits through a 36 in (914 mm) door opening and is 10 in (251 mm) shorter than our 50 lb (22.7 kg) unit, making it an option for laundries with limited space.

Performance

Available in 25 lb, 30 lb, 35 lb, 50 lb, 55 lb, 75 lb, 120 lb, 170 lb and 200 lb capacities, there's a tumble dryer to meet the needs of any on-premises laundry.

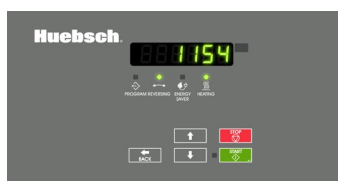

Galaxy™

The Galaxy Control offers the flexibility of 30 programmable cycles combined with the accuracy of our moisture-sensing technology saving time and energy increasing the life of your linens, saving time and energy.

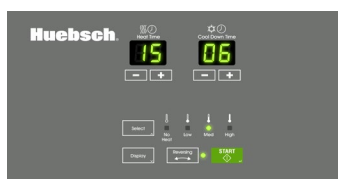

Dual Digital

With features including one-touch cycle repeat, automatic extended tumble and a large digital countdown display, it's simple to set your drying time, temperature and cool down with the Dual Digital Control.

On-Premises **120-lb Tumble Dryer** Specifications

MODEL		HT0120
CONTROL OPTION		Galaxy, Dual Digital
CAPACITY - lb (kg)		120 (54)
OVERALL WIDTH - in (mm)		46.1 (1170)
OVERALL DEPTH - in (mm)		67.9 (1725)
OVERALL HEIGHT - in (mm)		85.7 (2175)
CYLINDER DIAMETER - in (mm)		44 (1120)
CYLINDER DEPTH - in (mm)		41 (1040)
CYLINDER VOLUME - cu. ft. (liters)		36.1 (1020)
DOOR OPENING SIZE - in (mm)		26.9 (683)
ENERGY DATA	Gas Models - Per Pocket	270,000 Btu/hr
	Steam Models - Per Pocket	187,500 Btu/hr
	Electric Models	60kW
GAS CONNECTIONS - in (npt)		1
PLUMBING CONNECTIONS - STEAM - in (npt)	Inlet	0.75
	Outlet	0.75
AIR OUTLET - in (mm)		10 (254)
MOTOR -hp	Fan	1.5
	Cylinder	1.5
AIRFLOW - cfm		1400
ELECTRICAL SPECS - amps	Gas & Steam	
	Q	200-240V/50/60/3 7
	N	440-480V/50/60/3 4
	P	380-415V/50/60/3 4
	Electric	
	G	230-240V/50/60/3 147
	H	380V/50/60/3 94
	J	400-415V/50/60/3 86
	K	440V/50/60/3 82
	L	460-480V/50/60/3 75
SHIPPING DIMENSIONS	Width	48 (1220)
	Depth	71.5 (1820)
	Height	90 (2290)
NET WEIGHT - lb (kg)	Gas	1220 (555)
	Electric	1250 (575)
	Steam	1330 (605)
SHIPPING WEIGHT - lb (kg)	Gas	1290 (585)
	Electric	1320 (600)
	Steam	1400 (635)
AGENCY APPROVALS		CSA

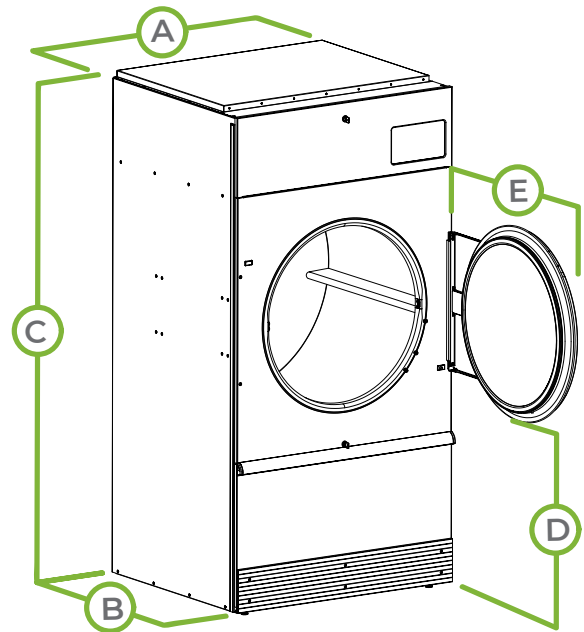

MODEL	HT120
A. OVERALL WIDTH - in (mm)	46.1 (1170)
B. *OVERALL DEPTH - in (mm)	67.9 (1725)
C. OVERALL HEIGHT - in (mm)	85.7 (2175)
D. DOOR BOTTOM TO FLOOR - in (mm)	31.4 (800)
E. DOOR SWING - in (mm)	32.5 (825)

Tumble dryer models are made to suit a variety of electrical service characteristics. See your Huebsch distributor for specifications. For further details on installation, refer to Installation, Operation and Maintenance instructions supplied with the tumble dryer. Amperage ratings available in Installation Manual.

For the most accurate information, the installation guide should be used for all design and construction purposes. Due to continuous product improvements, design and specifications subject to change without notice. The quality management system of Alliance Laundry Systems has been registered to ISO 9001.

On-Premises **170-lb Tumble Dryer** Specifications

MODEL		HT170
CONTROL OPTION		Galaxy, Dual Digital
CAPACITY - lb (kg)		170 (77)
OVERALL WIDTH - in (mm)		52.9 (1345)
OVERALL DEPTH - in (mm)		69.8 (1772)
OVERALL HEIGHT - in (mm)		94 (2390)
CYLINDER DIAMETER - in (mm)		50.8 (1290)
CYLINDER DEPTH - in (mm)		42.5 (1080)
CYLINDER VOLUME - cu. ft. (liters)		49.8 (1410)
DOOR OPENING SIZE - in (mm)		26.9 (683)
ENERGY DATA	Gas Models - Per Pocket	395,000 Btu/hr
	Steam Models - Per Pocket	265,500 Btu/hr
GAS CONNECTIONS - in (npt)		1
PLUMBING CONNECTIONS - STEAM - in (npt)	Inlet	0.75
	Outlet	1
AIR OUTLET - in (mm)		12 (305)
MOTOR -hp	Fan	1.5
	Cylinder	1.5
AIRFLOW - cfm		2150
ELECTRICAL SPECS - amps	Gas & Steam	
	Q	200-240V50/60/3 11
	N	440-480V/50/60/3 6
	P	380-415V/50/60/3 7
SHIPPING DIMENSIONS APPROX. - in (mm)	Width	52.1 (1320)
	Depth	73.8 (1870)
	Height	99 (2510)
NET WEIGHT - lb (kg)	Gas	1400 (635)
	Steam	1550 (705)
SHIPPING WEIGHT - lb (kg)	Gas	1480 (670)
	Steam	1630 (740)
AGENCY APPROVALS		CSA

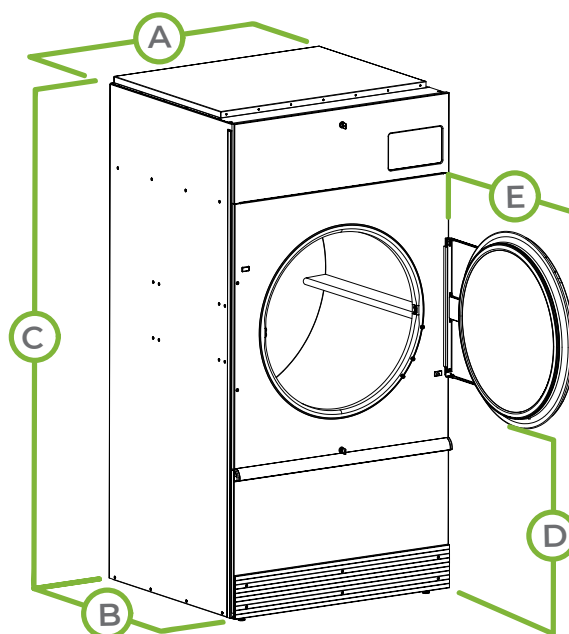

MODEL	HT170
A. OVERALL WIDTH - in (mm)	52.9 (1345)
B. *OVERALL DEPTH - in (mm)	69.8 (1772)
C. OVERALL HEIGHT - in (mm)	94 (2390)
D. DOOR BOTTOM TO FLOOR - in (mm)	33.9 (860)
E. DOOR SWING - in (mm)	32.5 (825)

Tumble dryer models are made to suit a variety of electrical service characteristics. See your Huebsch distributor for specifications. For further details on installation, refer to Installation, Operation and Maintenance instructions supplied with the tumble dryer. Amperage ratings available in Installation Manual.

For the most accurate information, the installation guide should be used for all design and construction purposes. Due to continuous product improvements, design and specifications subject to change without notice. The quality management system of Alliance Laundry Systems has been registered to ISO 9001.

On-Premises **200-lb Tumble Dryer** Specifications

MODEL		HT200
CONTROL OPTION		Galaxy, Dual Digital
CAPACITY - lb (kg)		200 (91)
OVERALL WIDTH - in (mm)		52.9 (1345)
OVERALL DEPTH - in (mm)		77.3 (1965)
OVERALL HEIGHT - in (mm)		94 (2390)
CYLINDER DIAMETER - in (mm)		50.8 (1290)
CYLINDER DEPTH - in (mm)		50 (1270)
CYLINDER VOLUME - cu. ft. (liters)		58.6 (1660)
DOOR OPENING SIZE - in (mm)		26.9 (683)
ENERGY DATA	Gas Models - Per Pocket	425,000 Btu/hr
	Steam Models - Per Pocket	265,500 Btu/hr
GAS CONNECTIONS - in (npt)		1
PLUMBING CONNECTIONS - STEAM - in (npt)	Inlet	0.75
	Outlet	1
AIR OUTLET - in (mm)		12 (305)
MOTOR -hp	Fan	3
	Cylinder	0.75
AIRFLOW - cfm		2150
ELECTRICAL SPECS - amps	Gas & Steam	
	Q	200-240V/50/60/3 12
	N	440-480V/50/60/3 6
	P	380-415V/50/60/3 7
SHIPPING DIMENSIONS APPROX. - in (mm)	Width	52.1 (1320)
	Depth	81.3 (2070)
	Height	99 (2510)
NET WEIGHT - lb (kg)	Gas	1550 (705)
	Steam	1700 (770)
SHIPPING WEIGHT - lb (kg)	Gas	1630 (740)
	Steam	1780 (805)
AGENCY APPROVALS		CSA

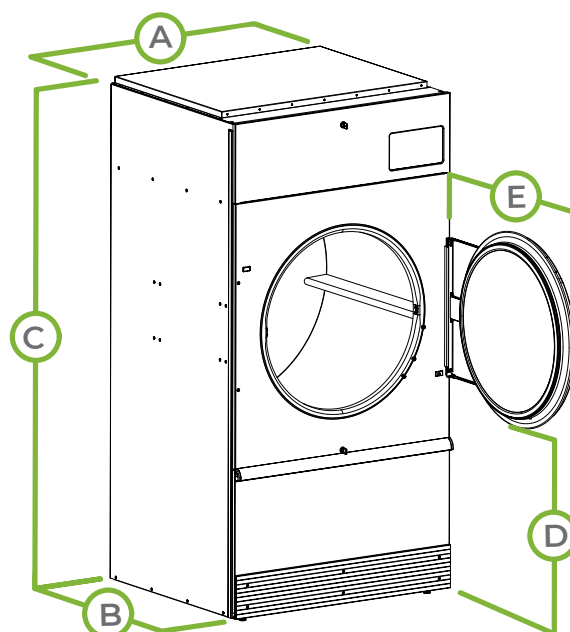

MODEL	HT200
A. OVERALL WIDTH - in (mm)	52.9 (1345)
B. *OVERALL DEPTH - in (mm)	77.3 (1965)
C. OVERALL HEIGHT - in (mm)	94 (2390)
D. DOOR BOTTOM TO FLOOR - in (mm)	32.1 (815)
E. DOOR SWING - in (mm)	34 (865)

Tumble dryer models are made to suit a variety of electrical service characteristics. See your Huebsch distributor for specifications. For further details on installation, refer to Installation, Operation and Maintenance instructions supplied with the tumble dryer. Amperage ratings available in Installation Manual.

For the most accurate information, the installation guide should be used for all design and construction purposes. Due to continuous product improvements, design and specifications subject to change without notice. The quality management system of Alliance Laundry Systems has been registered to ISO 9001.

OPL HARDMAOUNT WASHER-EXTRACTOR

PAN030TN0MZA20CTAA, PAN040TN0MZA20CTAA, PAN055TN0MZA20CTAA

XControl+ Cabinet Hardmount Washer-Extractor

FEATURES

- 200 G-Force
- Stainless steel cylinder and tub
- Anthracite gray front and side panels
- Soap box
- Large drain valve
- Front access to vital parts for easy maintenance

LIMITED WARRANTY

- 1-Year: door seal gaskets, water valve diaphragms, belts and internal hoses
- 5-Years: frame, cylinder shaft and bearings
- 3-Years: any parts not listed above



Fully programming XControl+

- 20 pre-set wash programs
- 99 programming cycles
- Graphical display



OPL CABINET HARDMOUNT WASHER-EXTRACTOR

SPECIFICATIONS

MODEL		PAN030TN0MZA20CTAA*	PAN040TN0MZA20CTAA*	PAN055TN0MZA20CTAA*
CAPACITY - lb (kg)		30 (13.5)	40 (18)	55 (24)
OVERALL WIDTH - in (mm)		29.53 (750)	35.03 (890)	35.03 (890)
OVERALL DEPTH - in (mm)		35.43 (900)	36.02 (915)	41.73 (1,060)
OVERALL HEIGHT - in (mm)		48.22 (1,225)	55.51 (1,410)	55.51 (1,410)
CYLINDER DIAMETER - in (mm)		24.40 (620)	29.53 (750)	29.53 (750)
CYLINDER DEPTH - in (mm)		17.72 (450)	16.14 (410)	21.46 (545)
CYLINDER VOLUME - in (mm)		4.8 (135)	6.4 (180)	8.5 (240)
DOOR OPENING SIZE - in (mm)		16.14 (410)	18.11 (460)	18.11 (460)
DOOR BOTTOM TO FLOOR - in (mm)		13.46 (342)	18.31 (465)	18.31 (465)
WATER INLET CONNECTION - in (mm)		2 x 0.75 (19)	2 x 0.75 (19)	2 x 0.75 (19)
DRAIN DIAMETER - in (mm)		1 x 3 (76)	1 x 3 (76)	1 x 3 (76)
DRAIN CENTER HEIGHT TO FLOOR - in (mm)		3.85 (98)	5.12 (130)	5.12 (130)
MOTOR POWER - HP (kW)		1 (0.75)	1.48 (1.1)	2.01 (1.5)
CYLINDER SPEED	Wash - RPM	46	42	42
	Extraction - RPM (G-Force)	760 (200)	690 (200)	690 (200)
VOLTAGE/ CIRCUIT BREAKER - FLA	(B) 120/60/1	20 - 13.3	—	—
	(Z) 200-240/60/1	10 - 7.2	15 - 9.1	15 - 9.2
SHIPPING DIMENSIONS APPROX. - in (mm)	Width	31.50 (800)	36.42 (925)	36.42 (925)
	Depth	37.4 (950)	38.19 (970)	44.49 (1,130)
	Height	53.35 (1,355)	61.02 (1,550)	61.02 (1,550)
NET WEIGHT - lb (kg)		419 (190)	695 (315)	728 (330)
STANDARD SHIPPING WEIGHT - lb (kg)		441 (200)	739 (335)	783 (355)
AGENCY APPROVALS		CSA	CSA	CSA

*** 7.9" base available**

For the most accurate information, the installation guide should be used for all installations, design and construction purposes.
 Due to continuous product improvements, design and specifications subject to change without notice.
 The quality management systems at Alliance Laundry Systems are registered to ISO 9001.



14404 Hoover St
 Westminster, CA 92683
 1-877-630-7278
 acelaundry.com